

WIRING:  
 RED = +24VDC  
 BLACK = GND  
 WHITE = +24VDC (OPEN), 0VDC (CLOSE)

WIRE LENGTH: 18" ± 1"

Parts List			
ITEM	QTY	PART NUMBER	DESCRIPTION
1	1	EP22A10320	EVX ACT 0.75S WWC 3W 24V
2	1	EVP20001	EV U-PIN
3	1	EVX100SLX	EVX 1" NPT SL BOLTED VALVE ONLY

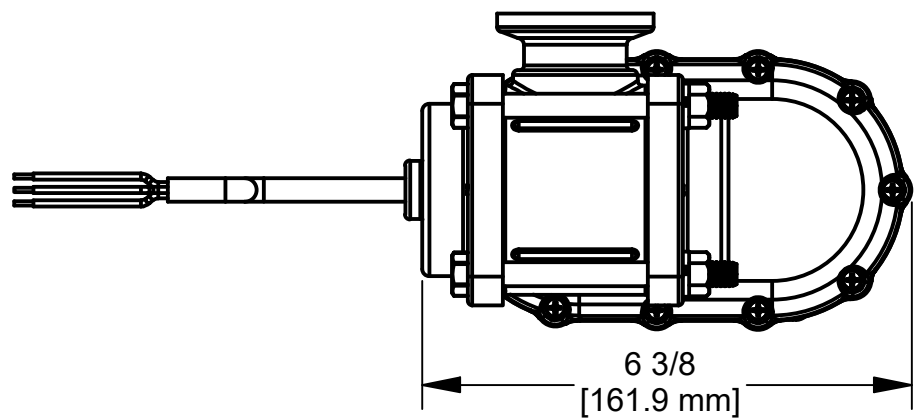
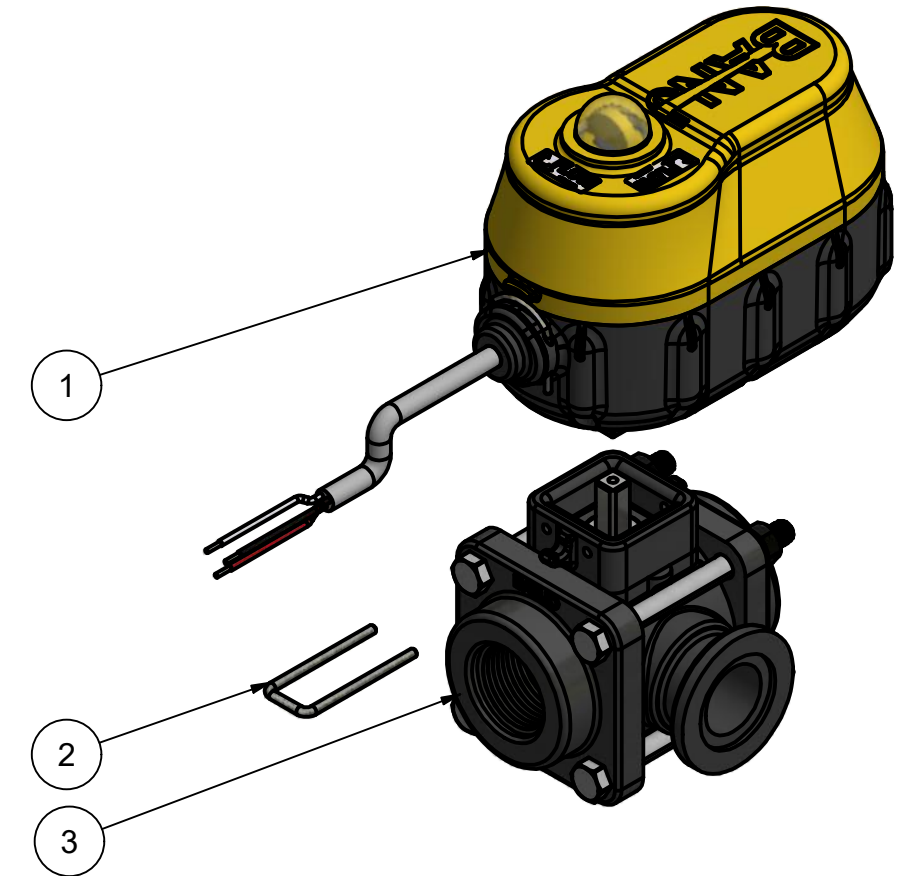
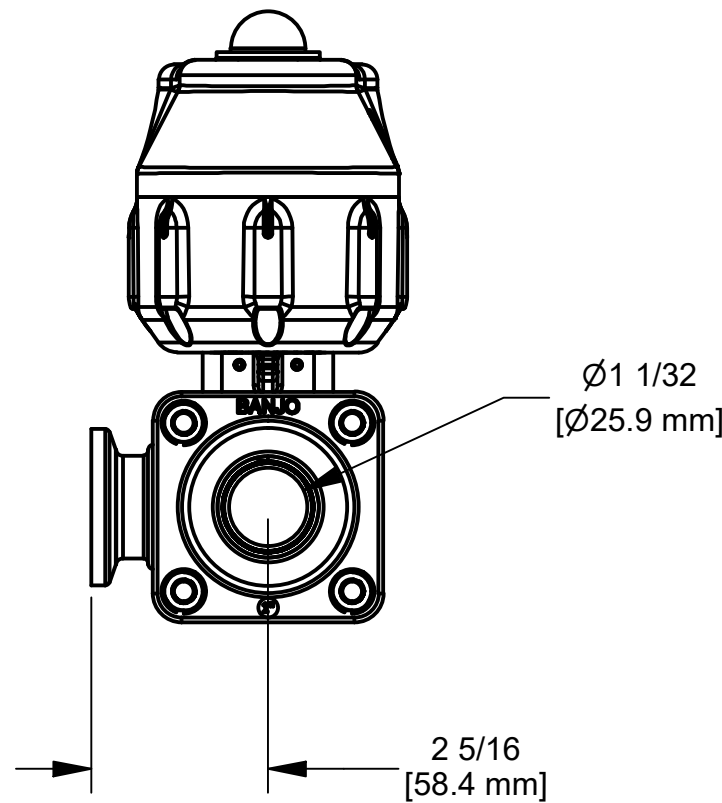
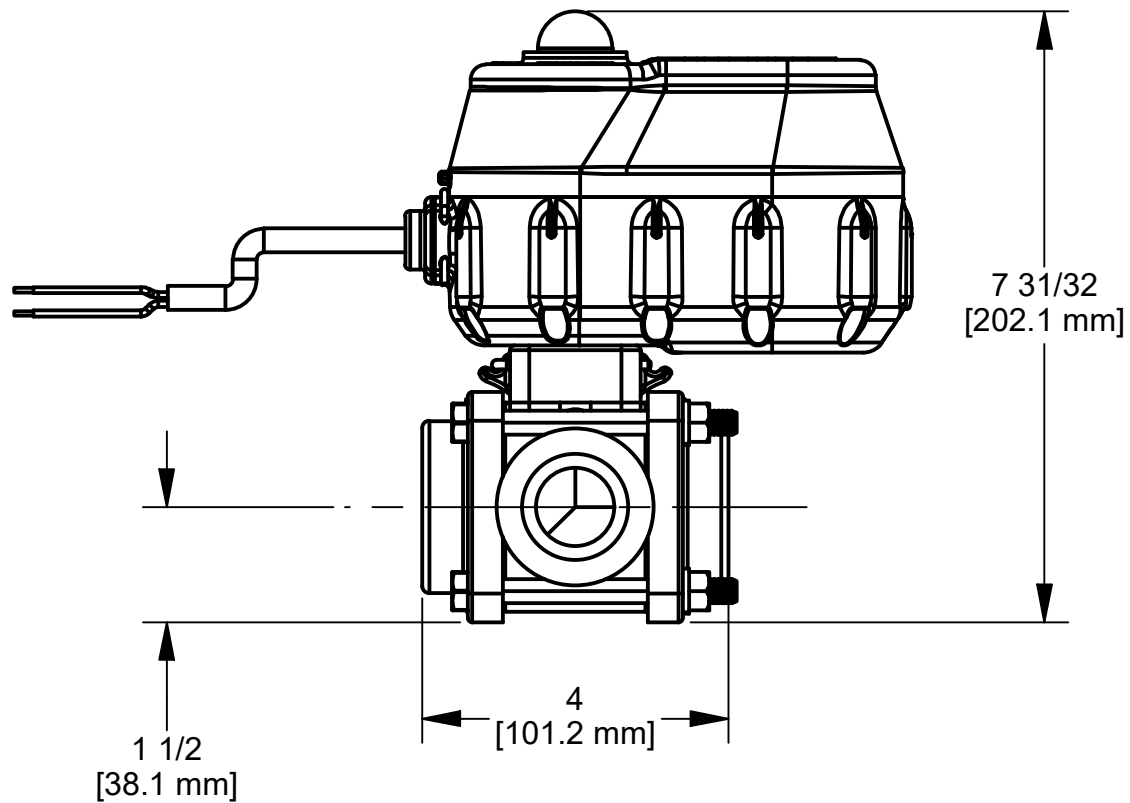

THIS DRAWING AND ALL INFORMATION CONTAINED THEREON ARE THE EXCLUSIVE PROPERTY OF BANJO CORPORATION.

UNLESS SPECIFICALLY NOTED, THIS DRAWING AND ITEMS SHOWN ON THIS DRAWING ARE SUBJECT TO CHANGE AT ANY TIME.

**BANJO CORPORATION**

BANJO CORPORATION  
 150 BANJO DRIVE, CRAWFORDSVILLE, IN 47933  
 WEB SITE: WWW.BANJOCORP.COM  
 E-MAIL: BANJOSALES@IDEXCORP.COM

DESCRIPTION  
 EVX 1"NPT SL 0.75S WWC 3W 24V

PART NUMBER  
 EVX100SL24